

TYPE K - MEASURING PROBE (NICR-NI) WITH DIN-TYPE FLAT-PIN PLUG

-65 °C  
+500 °C

**GOF 501**

Art. no. 475077

Surface probe for solid with silver measuring surface  
-65 ... +500 °C

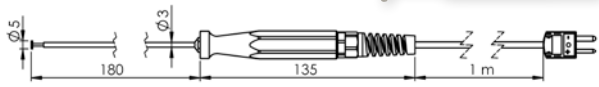

for any straight and solid surface; fixed silver plate, plastic handle, anti-buckling glanding, 1 m silicone cable, miniature flat plug

**Response time T<sub>90</sub>:** approx. 3 s

-65 °C  
+500 °C

**GOF 501 HO**

Art. no. 475072

Surface probe with silver measuring surface, angled  
-65 ... +500 °C

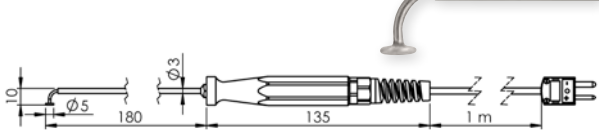

for any straight and solid surface, small elbow-type, fixed silver plate, plastic handle, anti-buckling glanding, 1 m silicone cable, miniature flat plug

**Response time T<sub>90</sub>:** approx. 3 s

-65 °C  
+500 °C

**GOF 130 CU**

Art. no. 600486

Surface probe for solid surfaces, fast  
-65 ... +500 °C

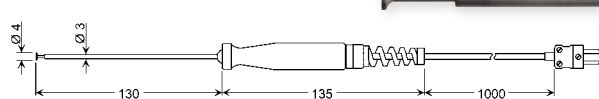

for any straight and solid surface  
Spring-loaded copper plate, plastic handle, anti-buckling glanding, 1 m silicone cable, miniature flat plug

**Response time T<sub>90</sub>:** approx. 5 s

-65 °C  
+550 °C

**GES 20-K**

Art. no. 602591

Core temperature- / food probe with compact teflon handle  
-65 ... +550 °C

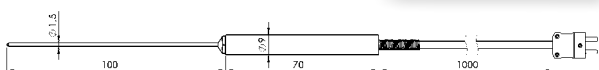

Use for canteen kitchen, bakeries, butcher's shops, etc.  
V4A tube with Ø 1.5 mm slim insertion tip, small Teflon handle, stainless steel kink protection, 1 m Teflon cable, miniature flat plug

**Response time T<sub>90</sub>:** water 0.4 m/s < 1 s, air 2 m/s approx. 12 s

-50 °C  
+250 °C

**GES 21-K**

Art. no. 600074

Core temperature- / food probe  
-50 ... +250 °C, potential free

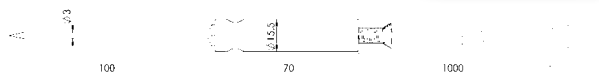

Use for canteen kitchen, bakeries, butcher's shops, etc.  
V4A tube Ø 3 mm with needle-shaped insertion tip, big white teflon handle, stainless steel kink protection, 1 m Teflon cable, miniature flat plug

**Response time T<sub>90</sub>:** water 0.4 m/s < 2 s, air 2 m/s approx. 40 s

-65 °C  
+550 °C

**GES 130**

Art. no. 600514

Insertion probe for soft media  
-65 ... +550 °C

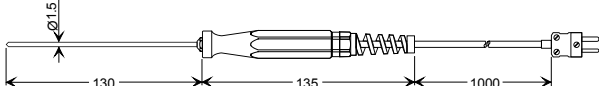

V4A tube with Ø 1.5 mm slim insertion tip, plastic handle, anti-buckling glanding, 1 m silicone cable, miniature flat plug

**Response time T<sub>90</sub>:** water 0.4 m/s approx. 1 s, air 2 m/s approx. 1.5 s

-65 °C  
+550 °C

**GES 500**

Art. no. 600516

Insertion probe for soft media  
-65 ... +550 °C



V4A tube with Ø 3 mm with needle-shaped insertion tip, plastic handle, anti-buckling glanding, 1 m silicone cable, miniature flat plug

**Response time T<sub>90</sub>:** water 0.4 m/s < 2 s

-65 °C  
+1000 °C

**GES 900**

Art. no. 600518

Insertion probe for soft media  
-65 ... +1000 °C



Spring-loaded V4A tube with slim Ø 3 mm insertion tip, plastic handle, anti-buckling glanding, 1 m silicone cable, miniature flat plug

**Response time T<sub>90</sub>:** water 0.4 m/s approx. 5 s

-65 °C  
+600 °C

**GTL 130**

Art. no. 602304

Air / gas probe  
-65 ... +600 °C

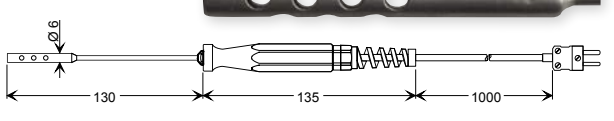

for room temperature, flue gases, etc.  
perforated V4A protective tube, fused thermocouple wires arranged behind, plastic handle, anti-buckling glanding, 1 m silicone cable, miniature flat plug

**Response time T<sub>90</sub>:** air 2 m/s approx. 15 s

-65 °C  
+200 °C

**GKF 125**

Art. no. 600520

Probe for compost, grain  
-65 ... +200 °C

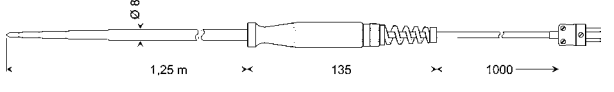

split-second response time, yet highly resilient  
V4A tube Ø 8 mm reduced to Ø 3 mm at the front, plastic handle, anti-buckling glanding, 1 m silicone cable, miniature flat plug

**Response time T<sub>90</sub>:** water 0.4 m/s approx. 6 s

-50 °C  
+250 °C

**GTF 40 K-620**

Art. no. 610829

Stainless steel insertion probe, t-handle  
-50 ... +250 °C, Type K, class 1, FL 620 mm

**GTF 40 K-1000**

Art. no. 475184

Stainless steel insertion probe, t-handle  
-50 ... +250 °C, Type K, class 1, FL 1000 mm

**GTF 40 K-1500**

Art. no. 475185

Stainless steel insertion probe, t-handle  
-50 ... +250 °C, Type K, class 1, FL 1500 mm

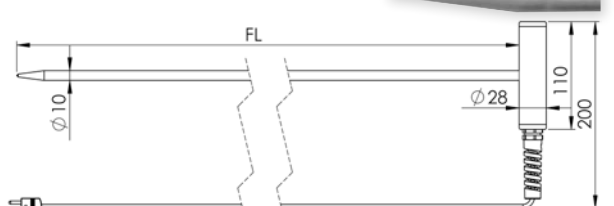

Stainless steel tube with 10 mm diameter and insertion tip, robust and ergonomic stainless steel T-handle, anti-buckling glanding, 1 m silicone cable, miniature flat plug

**Response time T<sub>90</sub>:** water 0.4 m/s approx. 6 s

HANDHELD INSTRUMENTS

SOFTWARE

ACCESSORIES

ALARM / PROTECTION, LEVEL